

Your Visit System

Push-Button Transmitter - Description

The Visit pushbutton transmitter is part of the Visit smart home system that helps you to keep tabs on your home. It works as a wireless doorbell and tells you when guests are at the door, so you can keep track of the comings and goings in your home. The pushbutton transmitter can also be used as a personal alarm to notify a relative or caregiver that you need assistance.

FEATURES

Reliable transmission

Up to 250m operating range

Flexible

Use as a doorbell or a personal alarm

Lightweight and durable

Withstands everyday use

Customizable signal

Choose an individual alert for each door

Long lasting power

Lasts up to 2 years on a standard battery



Buttons and connections

Status LED

Front button

Radio key switches

Signal switches

Hole for lanyard

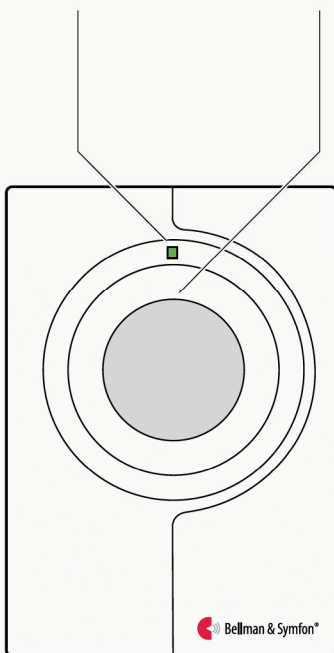

Front cover

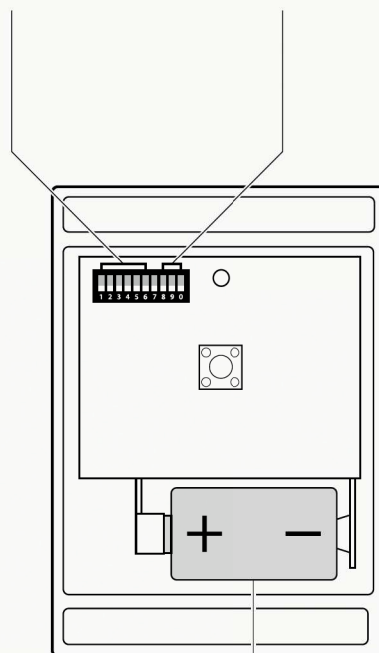

Pre-mounted battery

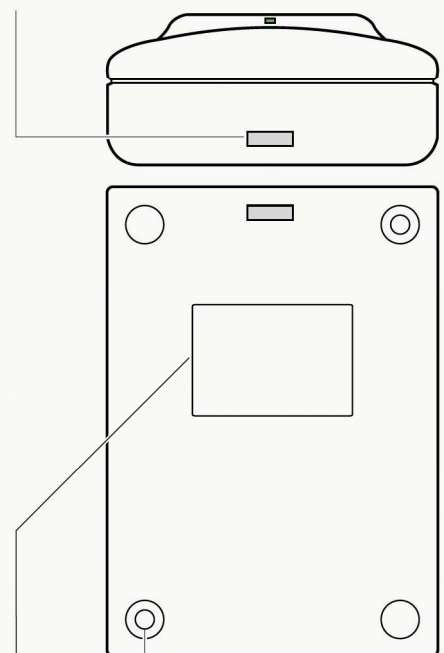

Adhesive tape

2 × hole markings

Your Visit System

Push-Button Transmitter - Handy Hints

This transmitter is often installed as a Doorbell and mounted out in the elements at the front door, in spite of the User Guide clearly stating 'Indoor Use Only'....

The BE1240 very rarely fails. The worst you can expect is yellowing as the plastic succumbs to UV radiation. Moisture may get inside which causes corrosion and failure.

If you must mount outside, please consider a little extra weather protection: Purchase a tube of Selleys All Clear Sealant, available from any hardware store.



Select a suitable position and ensure you can use woodscrews to secure the Push Button. Remember that steel reinforced concrete walls are likely to screen the signal. Test the device from the selected position before permanently mounting.

Carefully open the instrument using a 4mm flat blade screwdriver as follows:

- Insert the screwdriver in one of the slots at the side, push gently and give the screwdriver half a turn.
- Repeat for the slot at the other end, and the case will open a little.
- Repeat for the two slots on the other side and the top will lift up, exposing the electronics and battery.

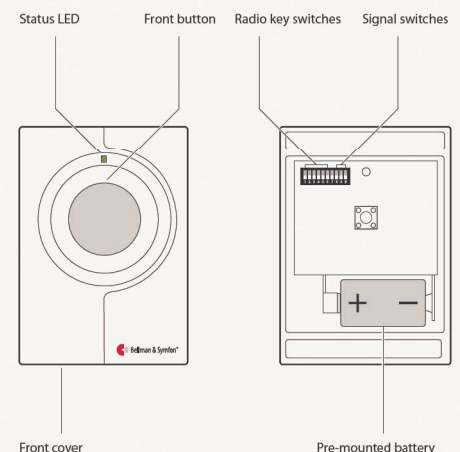

Look at the back of the main case and carefully drill a hole no more than 4mm diameter through each of the marked cut-outs, top right hand and lower left hand edges. Select two suitable screws (ask us to send them!) and attach the push button to the doorframe at a suitable height.

Apply sealant over the screw heads inside the top and bottom channel. Use enough to stop moisture leaching through the screw holes.

Apply a very thin layer of sealant to the inside frame of the cover and carefully clip it back on. Try not to spread the sealant around the electronics and carefully wipe off any excess sealant on the outside. Don't use any solvent or cleaner to remove this excess!

The battery is an LR44, 6 Volt, available from Reid Technology. Use the black ribbon to pull it out, and roll the new battery in the ribbon before refitting, making it easier for the next person!

